

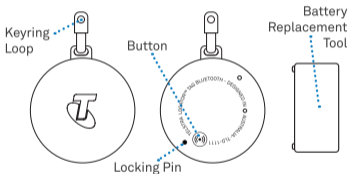

Telstra Track and Monitor Bluetooth® Tracking Tag

Quick Start Guide



Package Contents

- 1 x Bluetooth® Tracking Tag
- 1 x Battery Replacement Tool
- 1 x Quick Start Guide
- 1 x Warranty Leaflet

Turning on your tracking tag

The tracking tag will be in shipping mode when first removed from its packaging. Please follow the below steps to activate:

1. Press the button on the back of the tracking tag, it will play a tone to confirm it has powered on.

Note: Pressing the button subsequent times will play a tone and not affect the ongoing operation of the device.

2. Navigate to <http://trackandmonitor.telstra.com> or alternatively search for Telstra Track and Monitor app on the Google Play Store or Apple App Store.
3. Log in with your Telstra ID to finalise setup and configuration.

Troubleshooting and FAQs

If you experience any issues during the install and setup of this tracking tag please refer to telstra.com/assettracking for assistance.

Tracking tag information

The tracking tag lists key identifiers (including the MAC address) on the box. After initial activation, the MAC address is the identifier which you will use with the Track and Monitor web portal or Mobile app, or when you call Telstra for assistance.



Safety

A reminder that you are responsible for arranging installation of the tracking tag(s) on your assets and the installation should be completed in a way which complies with all relevant health and safety regulations and requirements.

**Battery
Replacement Tool.**

**Keep this handy tool
in a safe place.**



WARNING

KEEP BATTERIES OUT OF REACH OF CHILDREN

Swallowing may lead to serious injury in as little as 2 hours or death, due to chemical burns, and potential perforation of the esophagus.

If you suspect a child has swallowed or inserted a button battery, immediately call the 24-hour Poisons Information Centre 13 11 26 or 000 for fast, expert advice.

When replacing the battery, make sure the back of the tracking tag is secured in place and the locking pin has engaged.

Do not use if the back of the tracking tag is not secure.

Dispose of used button batteries immediately and safely.